

**ALLDAY
& MILLER**



Warwick Crescent, Hayes, UB4 8RQ
£430,000

 2  1  1  D



Warwick Crescent, Hayes, UB4 8RQ

£430,000

- Two Double Bedrooms
- Off Street Parking
- Convenient For The Uxbridge Road
- Large Private Rear Garden
- Double Glazed Windows
- Good Condition
- Close to Highly Regarded Schools
- Separate Kitchen & Living Area
- Quiet Residential Location
- Gas Central Heating

Description

The accommodation comprises of a spacious reception room measuring 14' 4 X 11' 4, flowing into the fitted kitchen and dining area, which gives access to the rear garden.

To the first floor two generously sized bedrooms and a family bathroom.

The front of the property with a driveway benefiting from off street parking . To the rear a private garden with a decking area perfect for outside dining and entertainment.

Situation

Warwick Crescent a residential road with easy access to a number of local amenities including the Uxbridge Road with its variety of shops, restaurants and cafes. Hayes and Harlington Station being just a 9 minute drive away with the Elizabeth line giving links to central London. A number of highly regarded schools including Hayes Park and road links with the M4/M25 and the A40 all within a short drive.



Floor Plans

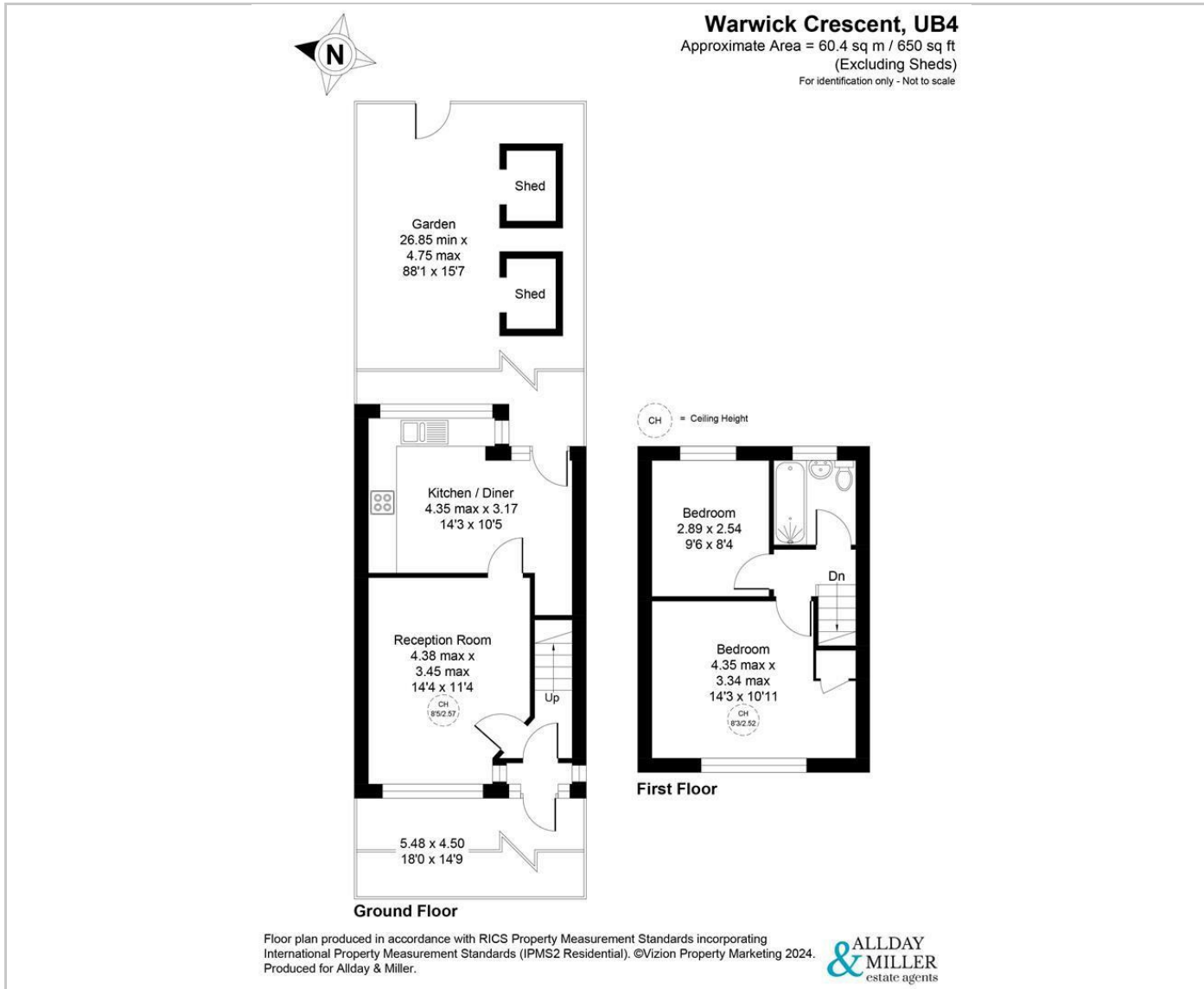

Area Map

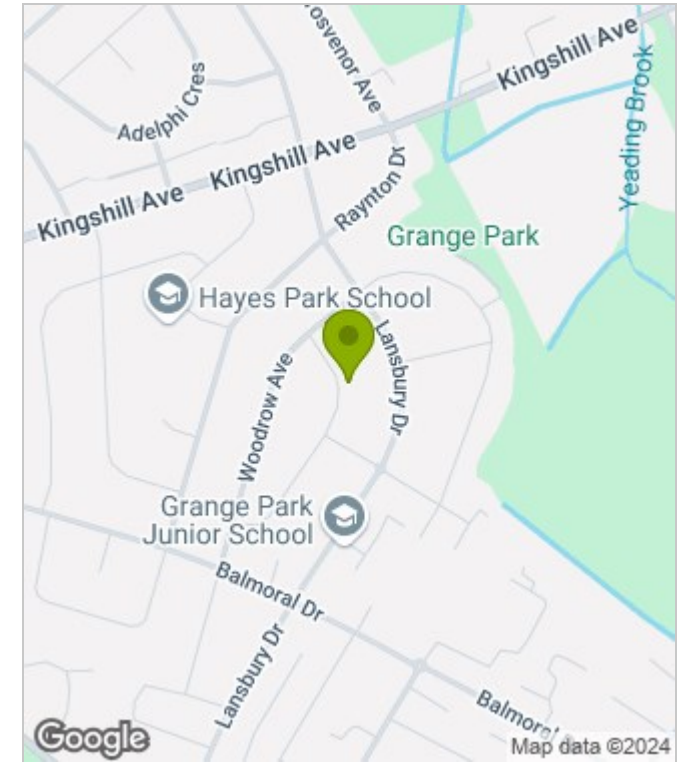

Energy Performance Graph

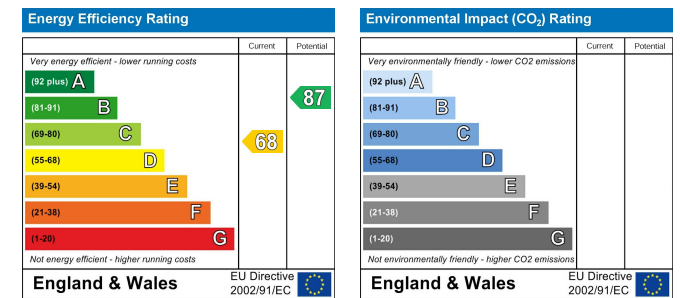

These particulars, whilst believed to be accurate are set out as a general outline only for guidance and do not constitute any part of an offer or contract. Intending purchasers should not rely on them as statements of representation of fact, but must satisfy themselves by inspection or otherwise as to their accuracy. No person in this firm's employment has the authority to make or give any representation or warranty in respect of the property.